

## Detaching Disk Safes in Data Center Console

Detaching a Disk Safe will delete the Disk Safe configuration from the CDP Server. All configured tasks and historical task information will be lost, but the Disk Safe and all backed up data will remain on the disk. In other words, the Disk Safe's folder will be kept.

**Note**  
You can detach only **closed** (disabled) Disk Safes.

Follow the instructions below to detach a Disk Safe in CDP.

1. Click on "Disk Safes" in the Main Menu to access the "Disk Safes" page.



2. Select a Disk Safe you want to detach and close it. See [Closing Disk Safes in Data Center Console](#).

3. After the Disk Safe is closed, it can be safely detached. Click on the "Detach" icon for this Disk Safe in the "Actions" column.

		Edit Selected		Vacuum Selected		Open Selected		Close Selected		Detach Selected	
<input type="checkbox"/>	CDP Server	Name	Agent	Volume	Size	Used	Status	Health	Actions	Actions	Actions
<input checked="" type="checkbox"/>	Ubuntu_CDP	D_safe	Agent_CentOS	Volume1	0	0	4 MB	✓	⊞	⊞	⊞
<input checked="" type="checkbox"/>	Ubuntu_CDP	dfld;lg	Agent_Ubuntu	volume2	0	0	4.1 MB	✓	⊞	⊞	⊞
<input type="checkbox"/>	Ubuntu_CDP	DiskSafe	Agent		Offline	Offline	Offline	Offline	Offline	⊞	⊞
<input type="checkbox"/>	Ubuntu_CDP	DS	Agent_Ubuntu		Offline	Offline	Offline	Offline	Offline	⊞	⊞

**Tip**

To find a Disk Safe, you can use the Basic and Advanced List Filters. See [Monitoring Disk Safes in Data Center Console](#).

**Note**

You can also detach several Disk Safes at once. See [Bulk Removal](#) below.

- Confirm your request to detach the Disk Safe by clicking on "Detach" in the displayed confirmation window.

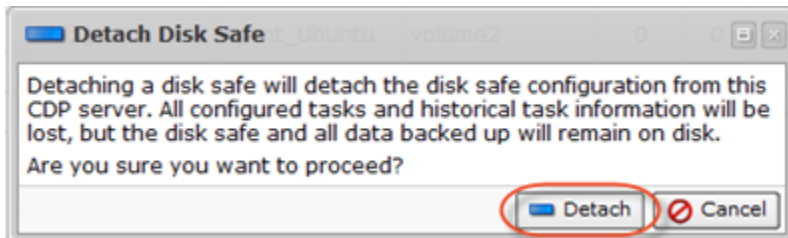

- The Disk Safe will disappear from the "Disk Safes" list.

**Bulk Detaching**

Using the Bulk Detaching, you can detach multiple Disk Safes at once.

- Select several Disk Safes by checking the related checkboxes in the first column in the Disk Safes list.

		CDP Server:		Name	Agent	Volume												
<input type="checkbox"/>	<input type="checkbox"/>	Ubuntu_CDP	D_safe	Agent_CentOS	Volume1	0	0	4 MB										
<input type="checkbox"/>	<input type="checkbox"/>	Ubuntu_CDP	dfid;lg	Agent_Ubuntu	volume2	0	0	4.1 MB										
<input checked="" type="checkbox"/>	<input checked="" type="checkbox"/>	Ubuntu_CDP	DiskSafe	Agent		Offline	Offlin	Offline	Offlin	Offlin								
<input checked="" type="checkbox"/>	<input checked="" type="checkbox"/>	Ubuntu_CDP	DS	Agent_Ubuntu		Offline	Offlin	Offline	Offlin	Offlin								

- Close the selected Disk Safes. See [Closing Disk Safes in Data Center Console](#).

- After the Disk Safes are closed, they can be safely detached. Click "Detach Selected" in the "Disk Safes" list toolbar.

		CDP Server:		Name	Agent	Volume												
<input type="checkbox"/>	<input type="checkbox"/>	Ubuntu_CDP	D_safe	Agent_CentOS	Volume1	0	0	4 MB										
<input type="checkbox"/>	<input type="checkbox"/>	Ubuntu_CDP	dfid;lg	Agent_Ubuntu	volume2	0	0	4.1 MB										
<input checked="" type="checkbox"/>	<input checked="" type="checkbox"/>	Ubuntu_CDP	DiskSafe	Agent		Offline	Offlin	Offline	Offlin	Offlin								
<input checked="" type="checkbox"/>	<input checked="" type="checkbox"/>	Ubuntu_CDP	DS	Agent_Ubuntu		Offline	Offlin	Offline	Offlin	Offlin								

- Confirm detaching of the selected Disk Safes by clicking on "Detach" in the displayed

confirmation window.

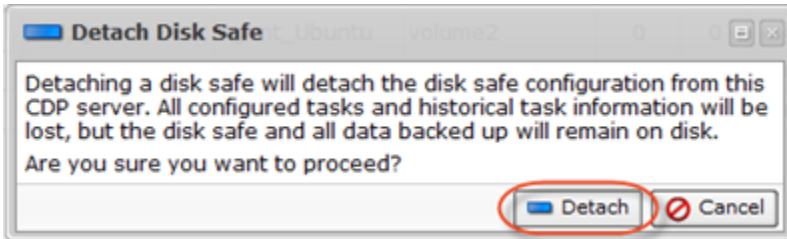

5. The Disk Safes will disappear from the "Disk Safes" list.

You can also detach Disk Safes using the "Disk Safes" tab of the Agent "Details" Pane. This screen provides the same functionality as the main "Disk Safes" screen. See more information in [Monitoring Agents in Data Center Console](#).